

Exposed portion of wall should have above grade waterproofing to prevent water from entering through wall face or construction joints and traveling down behind Paraseal

Continuous paraterm bar nailed every 8" O.C. Finish grade should occur at or below Paraseal waterproofing

Permanent Seam Tape at all vertical seams down to 18" below finish grade or any seam not orientated to shed water

Paraseal sheet lowered into place with bentonite side against substrate. Cover top 4" of Paraseal starter strip

**NOTE:** This detail and installation technique to be used only when space will not allow workers in the backfill area. Normal block walls to be waterproofed the same as concrete cast in place.

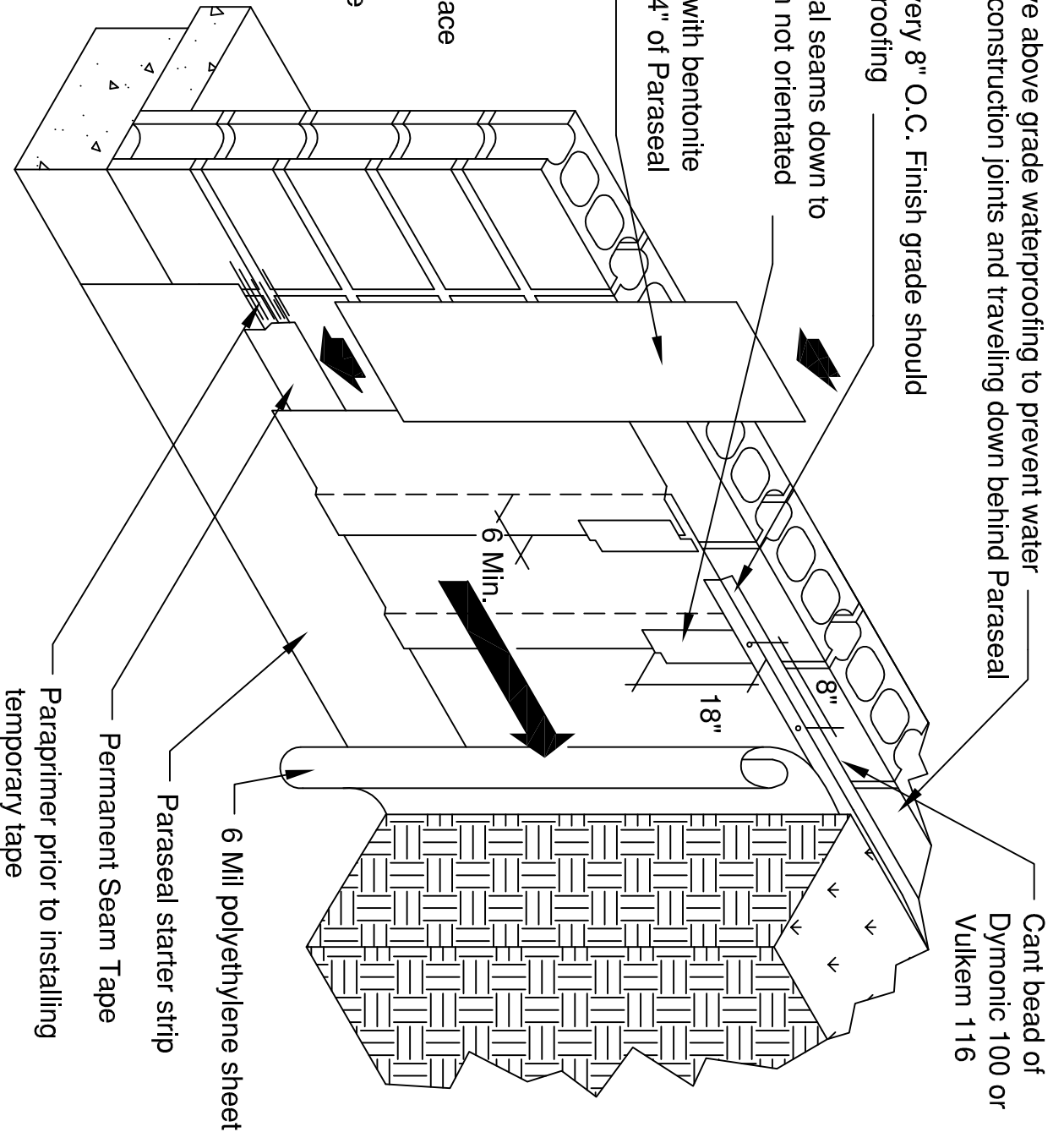

**Note:** Paraseal products require a minimum 24 psf compaction/ confinement to be effective.

This detail is intended for conceptual purposes only. Detail must be reviewed by a project/design professional. See [www.tremcosealants.com](http://www.tremcosealants.com) for the most up-to-date product information.

Rev	Date	Description	By
1	10/10/2013	Update Detail	KAB

**TREMCO**

[www.tremcosealants.com](http://www.tremcosealants.com)

3735 Green Road \* Beachwood, OH 44122  
Phone : 866-209-2404 \* Fax: 216-766-5535

Project: Backfilled Walls  
Detail: Paraseal Installation: Close Clearance at Masonry Wall

Drawn by: KT

Checked by: WH

Scale: None

Sheet Number:

Date: 7/31/2009

File Name:

10832

Rev #

1