

Note:

1. The applicator would slip a 1/2" diameter S.S. Washer and 1/4" thick Neoprene Washer over the threaded Nelson Stud welded to steel beam.
2. The applicator would then punch a 1/2" diameter or less hole in the Paraseal GM/LG membrane and slip the Paraseal GM/LG over the pre-installed Nelson Stud.
3. The applicator would install a 1/4" thick Neoprene Washer and then 1/2" inside diameter S.S. Washer over the Nelson Stud.
4. The applicator would install and tighten the 1/2" diameter threaded coupler and then apply Dymonic 100 sealant.

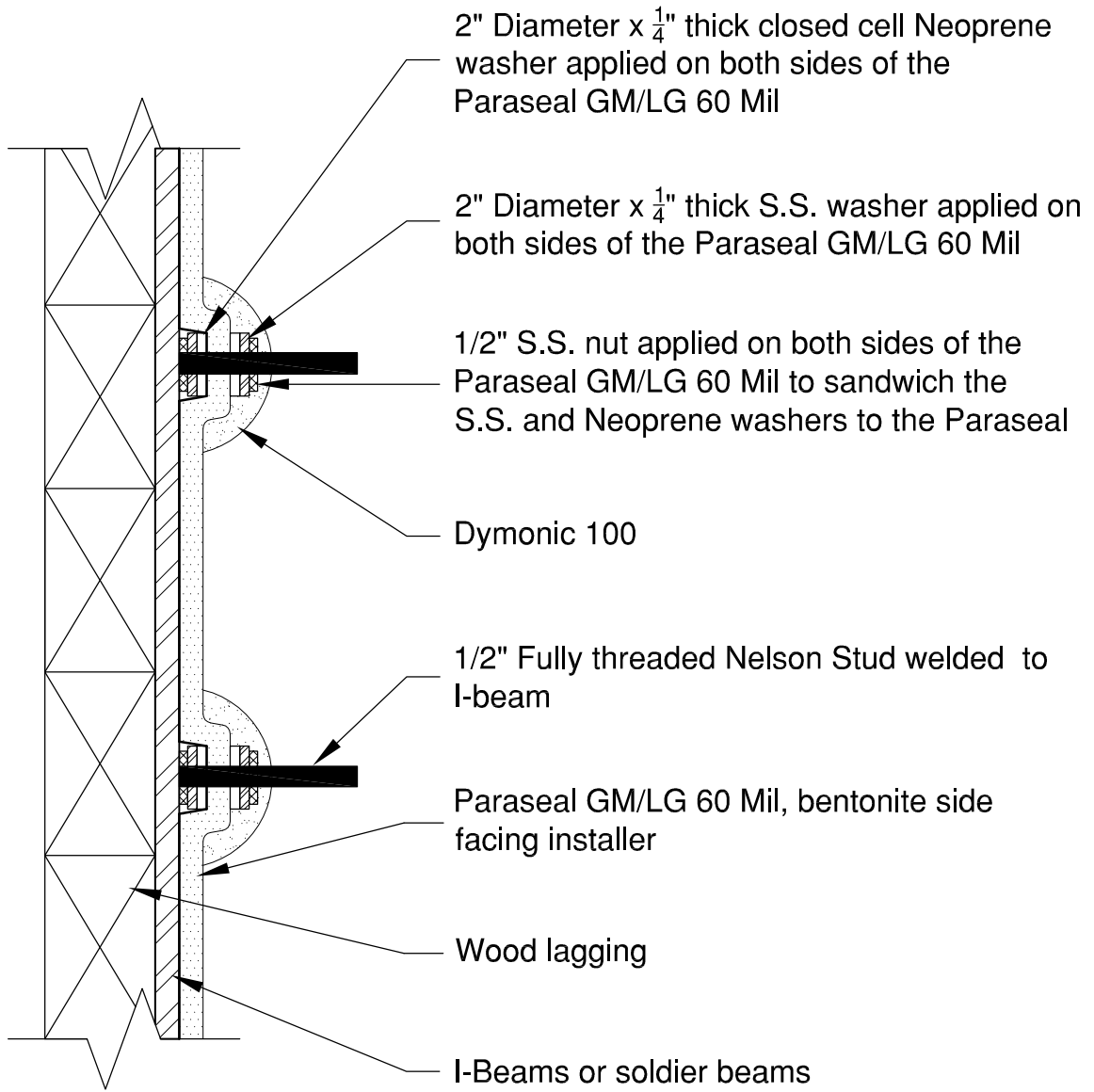

Note: Paraseal products require a minimum 24 psf compaction/ confinement in order to function as designed.

This detail is intended for conceptual purposes only. Detail must be reviewed by a project/design professional. See www.tremcosealants.com for the most up-to-date product information

Rev	Date	Description	By
-	-	-	-