

PRIME WITH TREMPRIME
NON-POROUS PRIMER

DYMONIC 100

VULKEM 351, 351NF OR 951NF
TOP COAT W/AGGREGATE

VULKEM 350, 350NF OR 360NF
BASE COAT

VULKEM 350, 350NF OR 360NF
DETAIL COAT

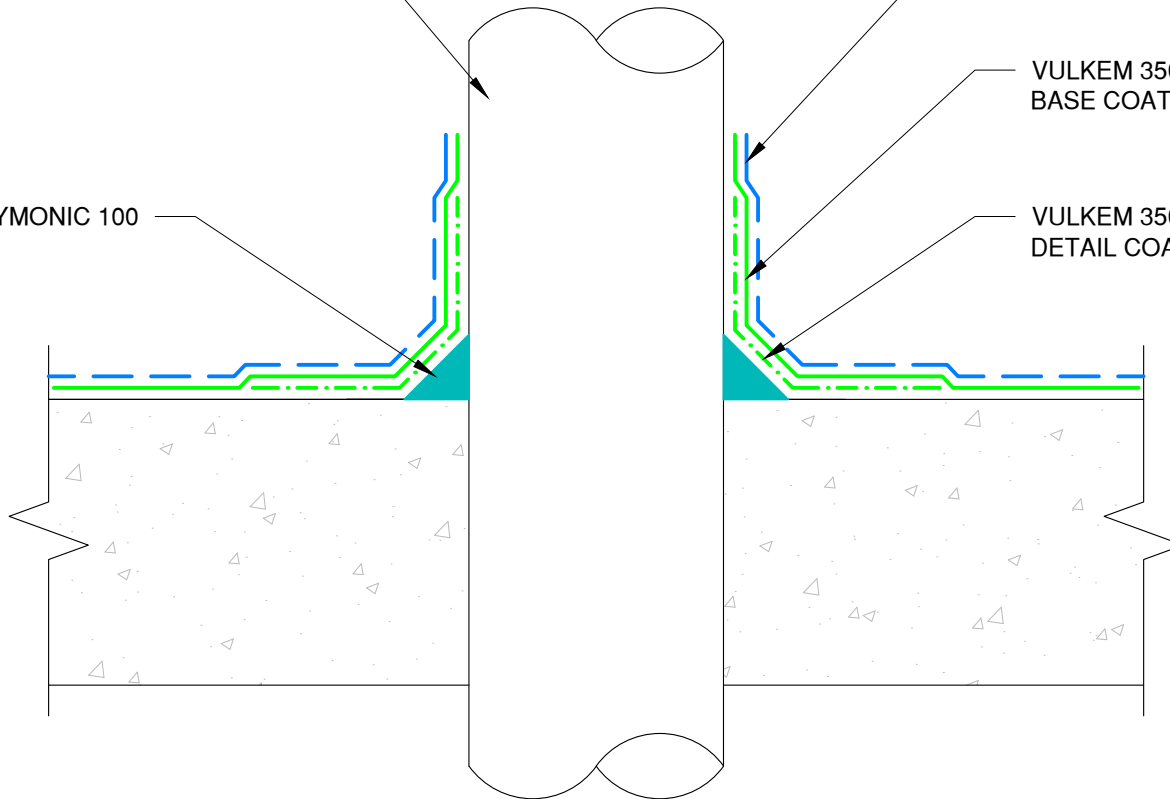

NOTE: VULKEM 950NF MAY BE USED AS A
TOPCOAT IN AREAS WITH NO U.V.



3735 Green Road, Beachwood, OH 44122
Phone : 866-209-2404

Detail: Treatment of Metal Penetration in Pedestrian System

Sheet Number:

File Name:

DC-P-P-02

This detail is intended for conceptual purposes only.

Drawn by: KAB

Checked by: WH

Scale: None

Date: 4/21/2020