

Paraterm Bar encapsulated  
with TREMproof 250 GC -T

Superstop Waterstop

TREMproof TRA Sheeting

TREMproof 250 GC at 30 mils

Vulkem 191 QD Primer

TREMproof 250 GC at 90 mils

TREMproof 250 GC at 60 mils  
or Dymonic 100

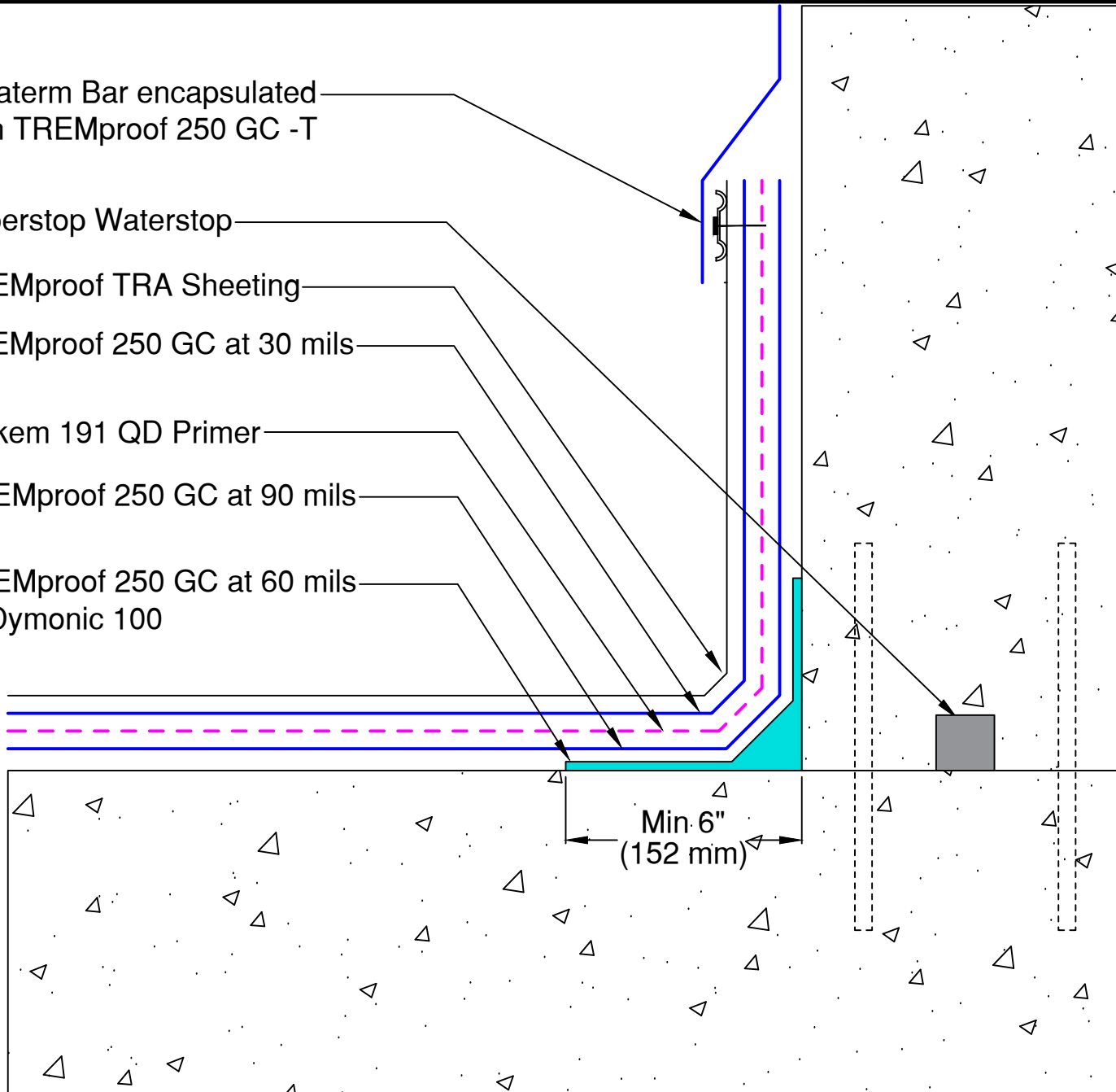

**TREMCO**

www.tremcosealants.com

3735 Green Road \* Beachwood, OH 44122  
Phone : 866-209-2404 \* Fax: 216-766-5535

Project: XXXXX

Detail: TREMproof DWS - Upturn

This detail is intended for conceptual purposes only.

Drawn by: MI

Checked by: DM

Scale: None

Sheet Number:

Date: 5/16/2016

File Name:

DWS-05  
15186

Rev #

00