

NOTE: Terminate TREMproof TRA Sheeting 6" past any change in plane or cold joint.

TREMproof TRA Sheeting

TREMproof 250 GC at 30 mils

Vulkem 191 QD Primer

TREMproof 250 GC at 90 mils

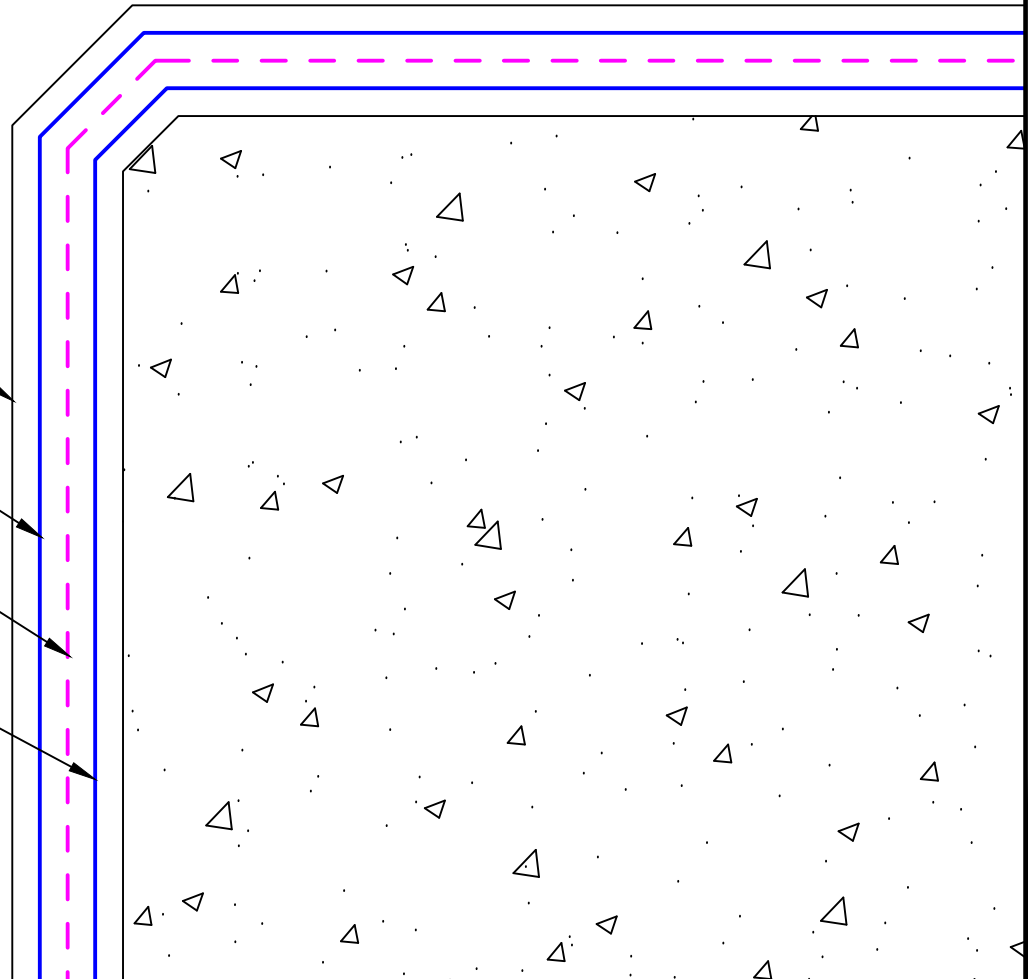

**TREMCO**

www.tremcosealants.com

3735 Green Road \* Beachwood, OH 44122  
Phone : 866-209-2404 \* Fax: 216-766-5535

Project: XXXXX

Detail: TREMproof DWS - Outside Corner - Chamfered Edge

This detail is intended for conceptual purposes only.

Drawn by: MI

Checked by: DM

Scale: None

Sheet Number:

Date: 5/16/2016

File Name:

DWS-06  
15187

Rev #

00